

# **OPTI – V**

---

# **DOUBLE - FABER**

## **SPARES MANUAL**

ISSUE 1

OCTOBER 2013

COMPLIED BY JOHN WILKINSON

# OPTI – V DOUBLE

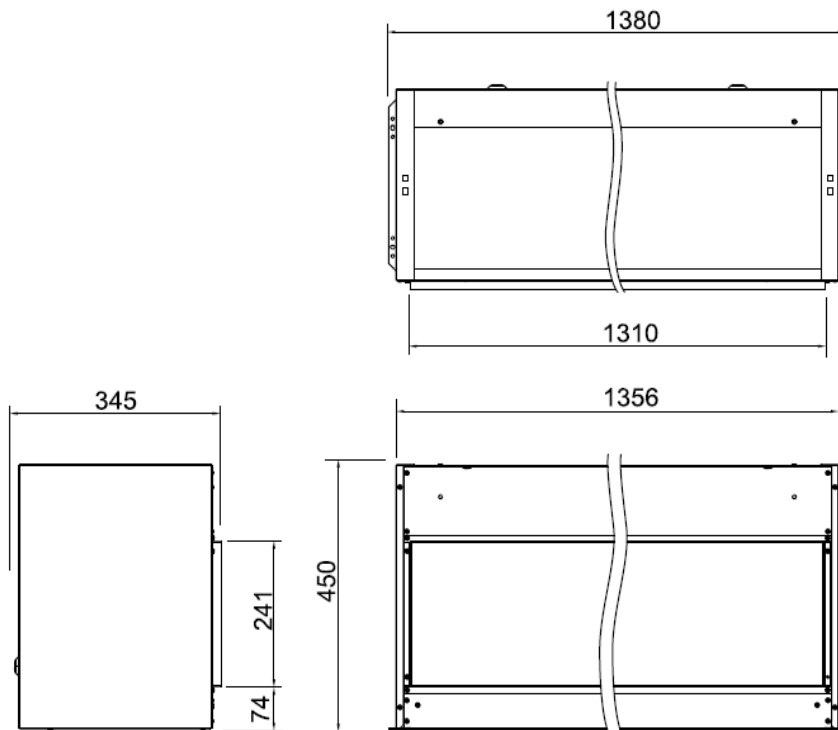

# OPTI – V DOUBLE

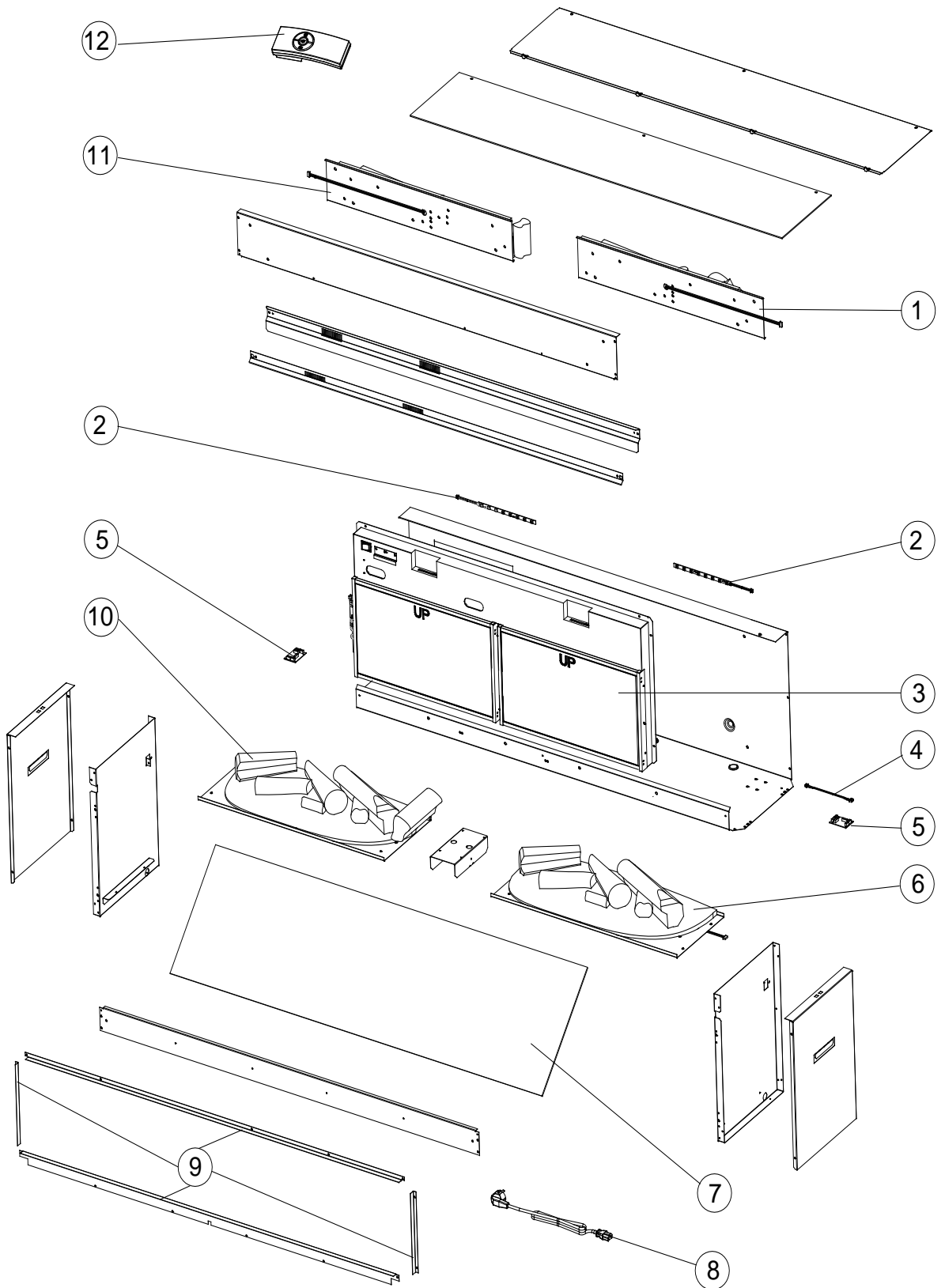

# OPTI – V DOUBLE

1	7513110	VIRTUAL FUELBED - RH
2	7513111	LED STRIP
3	7513112	DOUBLE SCREEN
4	7513113	4 WAY LV CABLE
5	7513114	LED CONTROLLER
6	7513115	HORIZONTAL FUELBED – RH
7	7513116	GLASS DOUBLE
8	DI13029	CORDSET EU
9	7513133	PASSEPARTOUT FRAME SET DOUBLE
10	7513117	HORIZONTAL FUELBED – LH
11	7513118	VERTICAL FUELBED – LH
12	DI13030	REMOTE CONTROL – FABER

# OPTI – V

## DOUBLE SCREEN

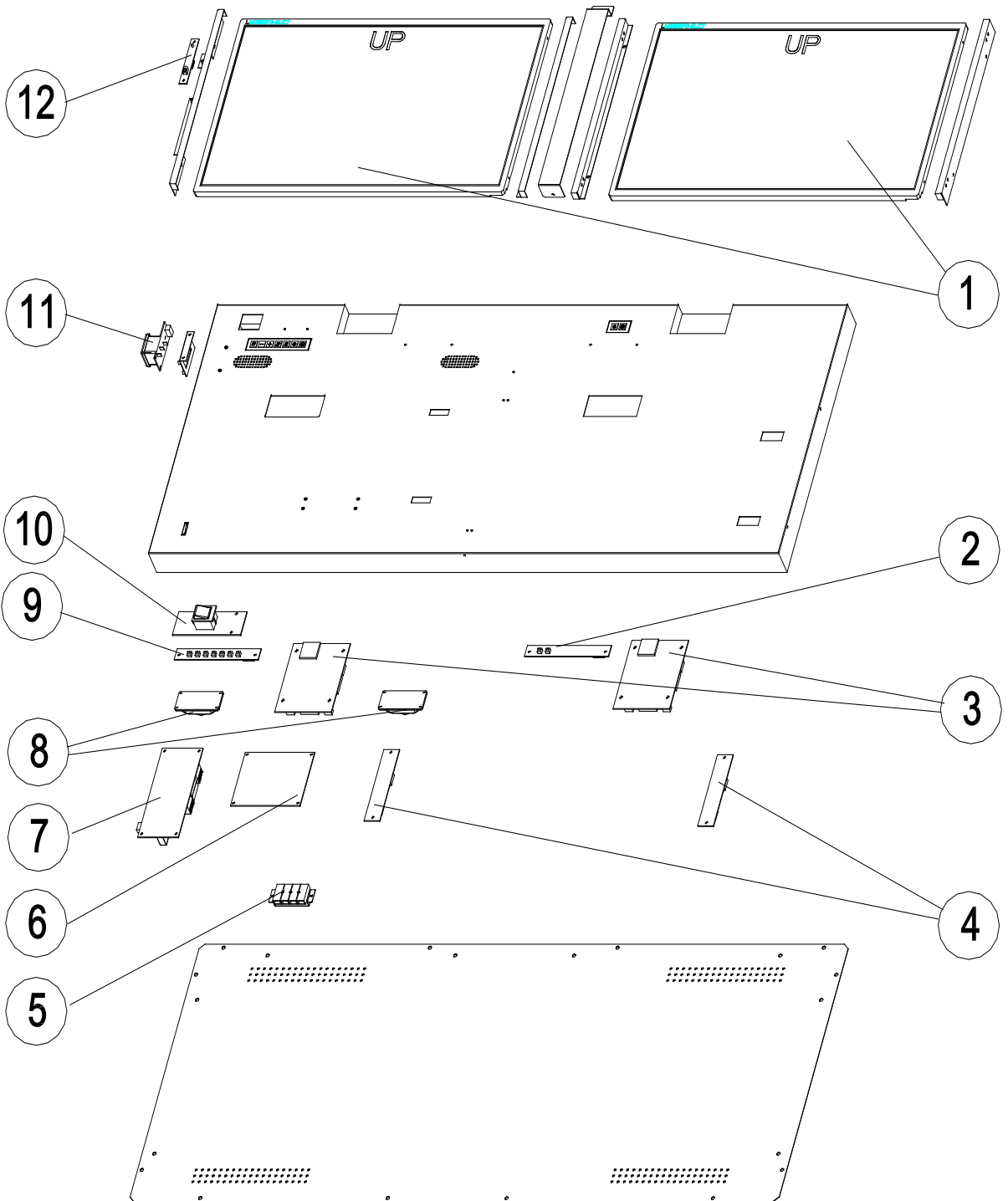

# **OPTI – V**

## **DOUBLE SCREEN**

1	7513120	LCD PANEL
2	7513121	OSD BOARD No.2
3	7513122	MAIN BOARD
4	7513123	CONVERTER
5	7513124	AC OUT CONNECTOR
6	7513125	POWER CONTROL BOARD
7	7513126	POWER BOARD
8	7513127	SPEAKER
9	7513128	OSD BOARD No.1
10	7513129	AC SWITCH BOARD
11	7513140	AC IN BOARD
12	7513130	IR BOARD

### **NOT SHOWN**

7513131	SD PROGRAMED MEMORY CARD
---------	--------------------------